



# TRUMP PLAZA HOTEL & CASINO

Conveniently located at the center of the Boardwalk, Trump Plaza is Atlantic City's premier meeting and convention destination. Boasting a \$25 million dollar casino floor renovation, new 24 hour restaurant and superior customer service, the Five Star Diamond Award Winning Trump Plaza has it all.

We invite you to visit our web site [www.trumpplaza.com](http://www.trumpplaza.com), your complete convention and meeting resource - submit an online RFP, view our function space, catering menus and more!

- ★ 906 newly appointed rooms and suites all with ocean or bay views
- ★ 24,000 square feet of function space all located on one level
- ★ Two short blocks to the Atlantic City Convention Center
- ★ Center Boardwalk location adjacent to Boardwalk Hall, across from The Pier Shops and The Walk Outlets
- ★ Three gourmet restaurants, a steakhouse, Asian fusion, regional Italian, the Liquid Bar and Jezebel's Casino Lounge; for more casual dining, 24 Central Cafe, China Cafe, Rain forest Cafe, EVO, Starbucks, Cafe Sbarro and 24 hour room service
- ★ The Plaza Spa, fitness room, full service salon and olympic-style indoor pool
- ★ Fine shops, headliner entertainment, unsurpassed luxury and 24-hour excitement

## **For More Group Meeting Information:**

Trump Plaza Hotel Casino  
Mississippi Avenue & Boardwalk  
Atlantic City, NJ 08401  
(609) 441-2708  
Fax (609) 441-8668  
[Gabe.rosales@trumpplaza.com](mailto:Gabe.rosales@trumpplaza.com)  
[www.trumpplaza.com](http://www.trumpplaza.com)

# TRUMP PLAZA

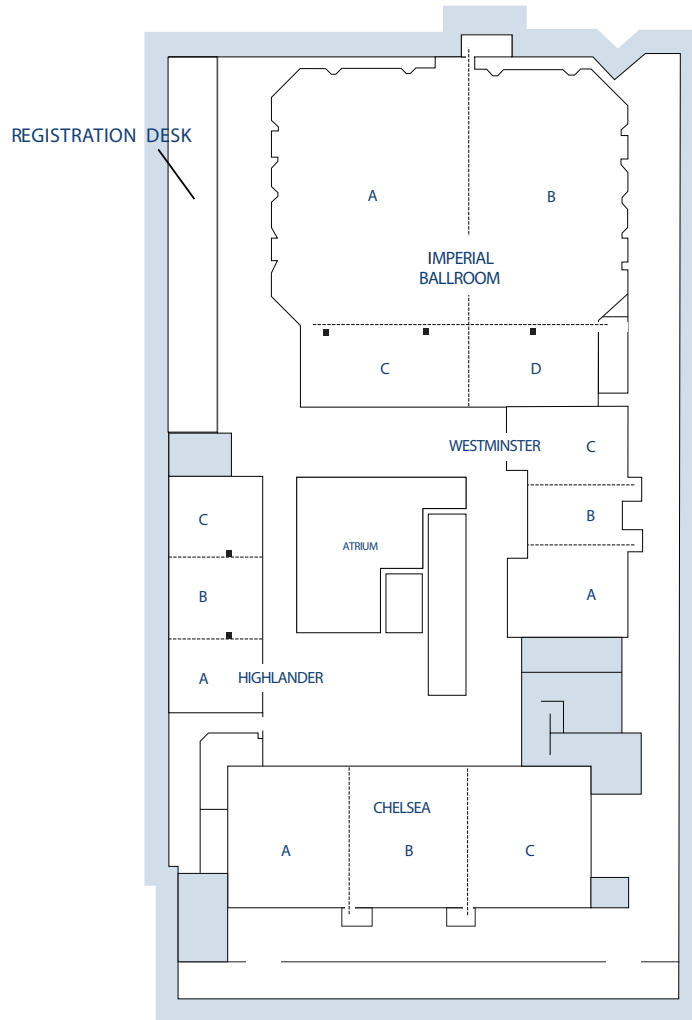

| Room                          | Theater | Class Room | Banquet | Conference | U-Shape | Square Feet | Dimensions  |
|-------------------------------|---------|------------|---------|------------|---------|-------------|-------------|
| Imperial Ballroom Total       | 1,060   | 552        | 832     | N/A        | 202     | 10,174      | 102.7'x99'  |
| Imperial Ballroom A           | 500     | 273        | 384     | 70         | 70      | 4,582       | 58'x79'     |
| Imperial Ballroom B           | 400     | 195        | 320     | 70         | 60      | 3,792       | 48'x79'     |
| Imperial Ballroom C           | 90      | 48         | 72      | 36         | N/A     | 1,000       | 50'x20'     |
| Imperial Ballroom D           | 70      | 36         | 56      | 28         | N/A     | 800         | 40'x20'     |
| Chelsea Rooms                 | 459     | 270        | 384     | 102        | 144     | 4,536       | 108'x42'    |
| Chelsea A                     | 153     | 90         | 128     | 34         | 48      | 1,512       | 36'x42'     |
| Chelsea B                     | 153     | 90         | 128     | 34         | 48      | 1,512       | 36'x42'     |
| Chelsea C                     | 153     | 90         | 128     | 34         | 48      | 1,512       | 36'x42'     |
| Westminster Rooms Total       | 192     | 96         | 144     | 70         | 81      | 2,394       | 101'x26'    |
| Westminster A                 | 75      | 36         | 56      | 25         | 29      | 936         | 36'x26'     |
| Westminster B                 | 42      | 24         | 32      | 25         | 23      | 522         | 29'x18'     |
| Westminster C                 | 75      | 36         | 56      | 25         | 29      | 936         | 36'x26'     |
| Highlander Rooms Total        | 104     | 42         | 96      | 40         | 48      | 1,125       | 25'x25'     |
| Highlander A                  | 52      | 21         | 48      | 20         | 24      | 525         | 21'x25'     |
| Highlander B                  | 52      | 21         | 48      | 20         | 24      | 600         | 24'x25'     |
| East Tower Multi-Purpose Room | 500     | 350        | 400     | -          | -       | 11,250      | 15'x94'150' |

# boardroom & beyond



AT TRUMP ENTERTAINMENT RESORTS<sup>SM</sup>, OUR 200,000 SQUARE FEET OF COMBINED MEETING SPACE IS ONLY THE BEGINNING.

- Over 3,500 deluxe guestrooms to relax in
- Superior Trump<sup>®</sup> service for an effortless meeting
- Central location for 1/4 of the nation's population
- Gourmet dining, high-end shopping, world-class casinos, great golfing and pampering spas and salons

We have it all, so you can do it all. Why meet anywhere else?

TRUMP TAJ MAHAL<sup>®</sup>  
609-449-6916

TRUMP PLAZA<sup>®</sup>  
609-441-6761

TRUMP MARINA<sup>®</sup>  
609-449-5165

# TRUMP

ENTERTAINMENT RESORTS

TAJ MAHAL PLAZA MARINA

ATLANTIC CITY

TRUMPMEEETINGS.COM